

BUB2002RW/BUB3002RW

Instruction Manual 使用说明书



This product is a replacement battery pack for BU2002RWL(G), BU3002RWL(G), and BU5002RWL(G).

Table of Contents

Safety precautions	1
1. Checking the contents	2
2. Replacing the battery	3
3. Notes of Chinese	7

Safety precautions Important information for safe operation is described. Be sure to read it before installation and start of use.

- The safety symbols and their meaning used in this manual are as follows:

 Warning	Misuse may cause death or serious injury.
 Caution	Misuse may cause injury or property damage.

* Property damage means damage to houses/household effects, livestock, and pets.

 : Indicates prohibition. For example,  indicates that disassembly is prohibited.

 : Indicates obligation. For example,  indicates that grounding is necessary.

Note that events categorized as a caution required matter also may cause more serious results under certain conditions.



Caution (for battery replacement)

Do not replace the battery in a place where there is flammable gas.

- Spark may occur when connecting the battery, which may cause an explosion or fire.



If fluid (dilute sulfuric acid) leaks from the battery, do not touch the fluid.

- Doing so may cause blindness or burns.
- If it contacts your eyes or skin, wash it out with lots of clean water and consult your doctor.



Do not disassemble or modify the battery.

- Doing so could cause dilute sulfuric acid leak, which could cause blindness and burns.



Do not drop the battery and do not expose it to strong impact.

- Dilute sulfuric acid may leak.



Do not short the battery with metal objects.

- Doing so could cause an electric shock, fire or burn.
- Some electrical energy still remains inside the spent battery.



Do not put the battery into fire and do not break it.

- The battery may explode or leak dilute sulfuric acid.



Do not use a new battery and an old battery at the same time.

- Dilute sulfuric acid may leak.
- A battery can present a risk of electrical shock and high short circuit current. The following precautions should be observed when working on batteries:
 - 1) Remove watches, rings, or other metal objects from the hands.
 - 2) Use tools with insulated handles.
 - 3) Wear rubber gloves and boots.
 - 4) Do not lay tools or metal parts on top of batteries.
 - 5) Disconnect charging source prior to connecting or disconnecting batteries terminals.
- Servicing of batteries should be performed or supervised by personnel knowledgeable of batteries and the required precautions. Keep unauthorized personnel away from batteries.



1. Checking the contents

Check whether all the package contents are included and there is no damage found on their appearance. If you should notice defects or anything wrong, contact us; OMRON representative.

- Instruction manual (Japanese/English) 1 each
- Spare screw 1
- Battery replacement date label 1

2. Replacing the battery

The battery can be replaced while the UPS is stopped (power supply output stopped).



Caution

When the UPS is used in compliance with UL standards or CE marking, battery replacement should be performed or supervised by personnel familiar with the danger of batteries and the required precautions.

- * When the battery replacement LED lights up/blinks and beeper sounds, press the beep stop/test switch for 0.5 seconds to stop the beeper. (Lighting/blinking of "battery replacement" LED does not disappear.)
- * If an input power supply error such as a power failure occurs when replacing the battery while in operation, backup cannot be performed and output stops.
- * Do not replace the battery during backup operation. Output will stop.

UPS battery replacement procedure

1. Use a screwdriver to loosen (turn counter-clockwise) the screw on the right side of the front panel of the UPS. (There is no need to remove the screw.)
Pull the right side of the front panel towards you to remove it.

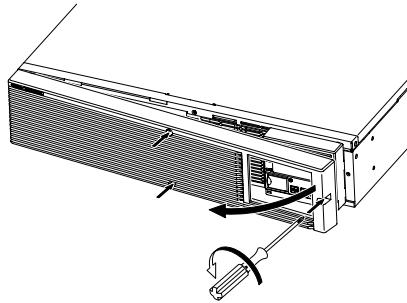

2. Remove the battery cover.

BU2002RWL(G)/BU3002RWL(G):

Use a screwdriver to loosen (turn counter-clockwise) the screw that holds the battery cover in place ①. (There is no need to remove the screw.)

Slide the battery cover to the right ② and pull it towards you to remove it ③.

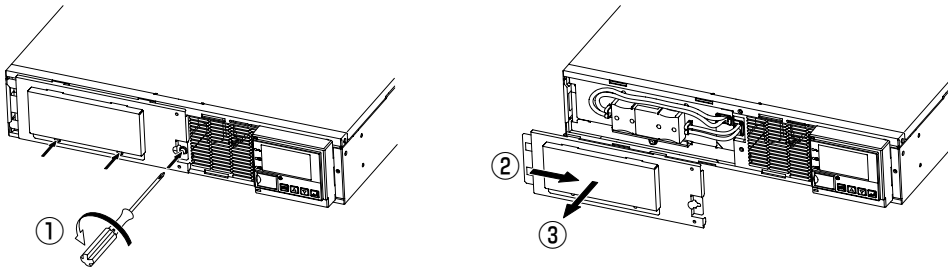

BU5002RWL(G):

Use a screwdriver to remove (turn counter-clockwise) the screw that holds the battery cover in place ①. (Be careful not to lose the removed screw.)

Slide the LCD to the left ②, flip it up ③, and then slide the LCD to the right ④ to keep it flipped up.

Then, slide the battery cover to the right ⑤ and pull it towards you ⑥ to remove it.

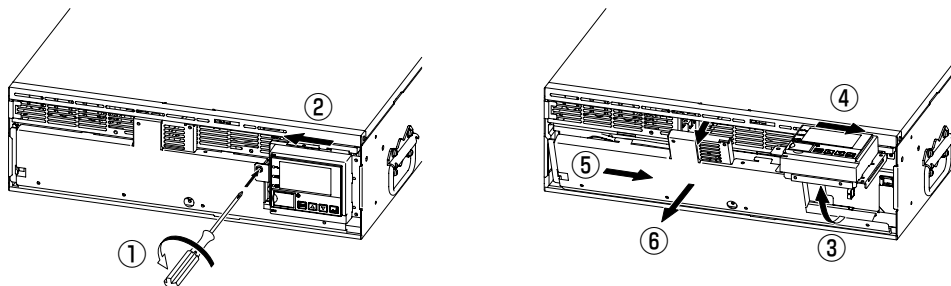

3. Pull the both ends of the battery connector to disconnect the connector.

4. Remove the battery pack by pulling the L-type hold on the front face of the battery pack.

Caution: Do not hold the battery pack by the connector or cable.
CAUTION: RISK OF EXPLOSION IF BATTERY IS REPLACED BY AN INCORRECT TYPE.
DISPOSE OF USED BATTERIES ACCORDING TO THE INSTRUCTIONS.

Use the red line on the label on top of the battery pack, which is 10 cm from the inner edge of the battery, to gauge how much further you need to pull the battery to remove it. Hold the battery securely with both hands so as not to drop it.

BU2002RWL(G)/BU3002RWL(G):

BU5002RWL(G):

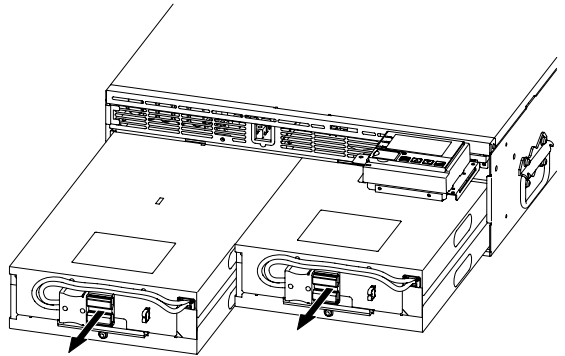
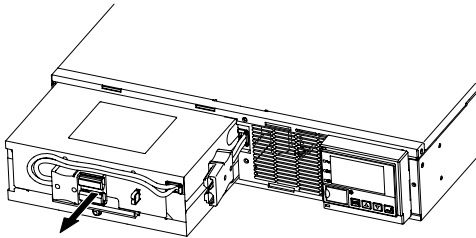

5. Insert the new battery upright into the unit as far as it will go.

● Replacement battery pack

For BU2002RWL(G): Model BUB2002RW

For BU3002RWL(G): Model BUB3002RW

For BU5002RWL(G): Model BUB3002RW (two packs required)

	BU2002RWL(G)	BU3002RWL(G)	BU5002RWL(G) (two packs required)
Nominal voltage of total battery strings	DC48V (12V×4PCS)	DC72V (12V×6PCS)	
Nominal capacity of each battery	7.8Ah		



● CONTAINS SEALED LEAD-ACID BATTERY.

● BATTERY MUST BE RECYCLED.

BU2002RWL(G)/BU3002RWL(G):

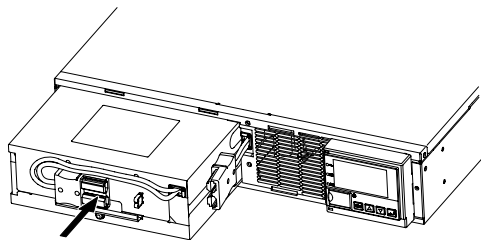

BU5002RWL(G):

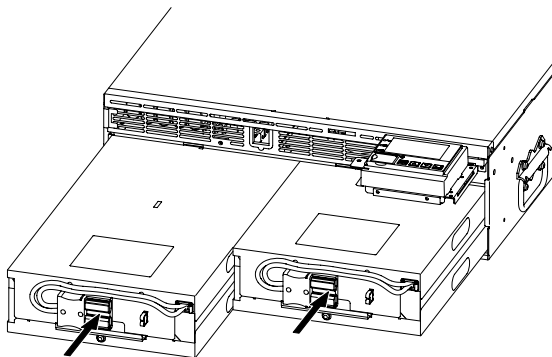

6. Insert the connector of the battery pack.

You may hear a “pop” sound when you insert the battery connector, but this is normal. Check that the battery connectors and battery cables are as shown below.

BU2002RWL(G)/BU3002RWL(G):

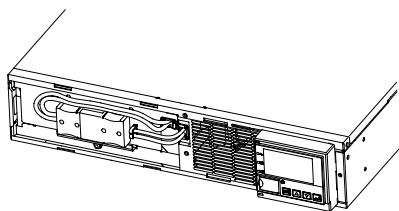

BU5002RWL(G):

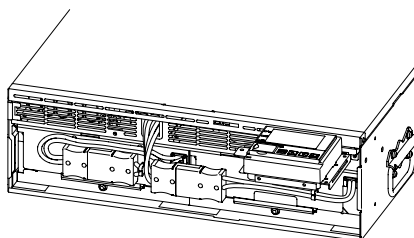

7. Attach the battery cover.

BU2002RWL/BU3002RWL:

Attach the battery cover in the reverse order of removing the cover.

First hook the tabs on the bottom of the battery cover onto the unit, then insert the tabs on the top of the battery cover into the slots on the unit ①, and then slide the battery cover to the left ②.

Fix the battery cover with the screw ③.

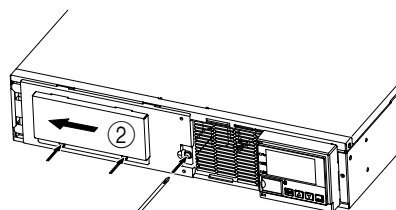
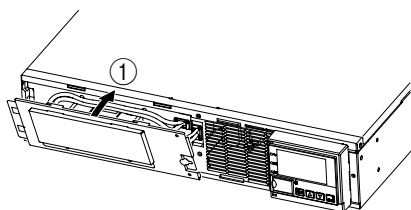

Tightening torque 0.9Nm (8 lb-in)

BU5002RWL:

Attach the battery cover in the reverse order of removing the cover.

First attach the battery cover ①, and slide the cover to the left and hold it ②.

Slide the LCD section to the left ③ and pull it down ④, and then slide it to the right ⑤.

The LCD section returns to its original state.

Fix the battery cover with the screw ⑥.

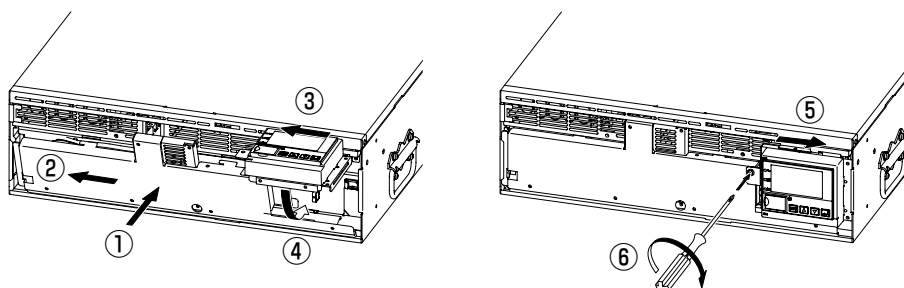

8. Attach the front panel.

Insert the tab on the left side of the front panel into the hole in the main unit, and push the front panel against the main unit.

Use a screwdriver to securely tighten (turn clockwise) the screw on the right side of the front panel.

Be careful not to get your fingers caught when attaching the front panel.

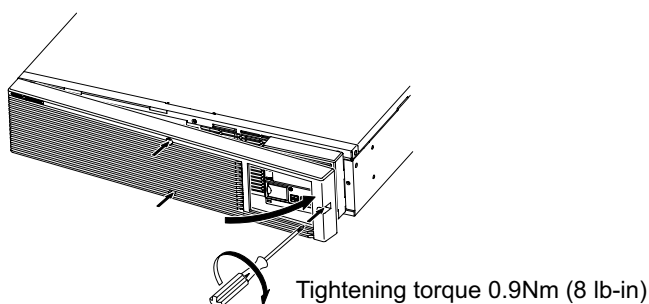

Battery replacement is complete.



<Be sure to reset the battery life counter after replacing the battery.>

After replacing the battery, reset the battery life counter from the "Control" - "ResetB.L.cnt" screen on the LCD menu of the UPS.

If you do not reset the battery life counter, a battery replacement alarm may occur faster than the expected battery life.



Write the battery replacement date on the included battery replacement date label, and attach the label to the UPS. Or, enter the battery replacement date from the "Settings" - "Batt. Settings" - "Bat.Inst.Date" screen on the LCD menu.

3. Notes of Chinese

扩展电池模块使用说明书

本文是更换不间断电源（以下简称 UPS）内置电池模块时的使用说明书。
详细内容请参照英文版使用说明书
（以下简称“Instruction Manual”）。

更换电池

无论 UPS 处于停止运转（停止输出电源）状态、还是正在运转状态（正在输出电源）均可执行电池更换。

- ※ 在停止运转状态下更换时，请停止连接设备的运转、关闭 UPS 的“电源输出”开关、并从电源插座上拔掉“AC 输入”插头。
- ※ 在运转状态下的电池更换中发生停电等输入电源异常时，会导致无法进入后备式运转而停止电源输出。
- ※ 请勿在后备式运转中更换电池。否则会导致输出停止。

1. 卸下 UPS 正面的前面板螺钉，拆除前面板。
螺钉位置请查看“Instruction Manual”。
2. 拆除位于前面板内侧的金属盖。
拆除方法请查看“Instruction Manual”。
3. 拔掉连接 UPS 和扩展电池的插头。
请一边握住插头主体一边拔去。
4. 请将新品扩展电池放入 UPS，然后连接插头。
5. 安装金属盖。
6. 安装前面板或外盖，并用螺钉紧固。

< 更换电池后，必须进行电池寿命计数器的复位。 >

更换电池后，请在不间断电源装置（UPS）的 LCD 菜单 [Control] — [ResetB. L. cnt] 画面，复位电池寿命计数器。若不进行电池寿命计数器的复位、可能会早于电池预期寿命发生电池更换报警。



请在附带的“电池更换日期”标签上填写更换电池的日期，并粘贴于不间断电源装置(UPS)上。或在 LCD 菜单[Settings]—[Settings]—[Bat. Inst. Date] 画面输入电池更换日期。

◆ 注意事项 ◆

本产品中使用了铅酸蓄电池（铅蓄电池）。

● 将换下无用的电池进行废物处理时，请联系咨询窗口。

电池可以保管（未使用状态）的期限是，自完全充电状态起约 6 个月左右。（保管温度在 25℃以下时。40℃以下时为 2 个月左右。）

● 电池即使不使用也会在内部自然放电，长时间放置后会呈现过放电状态，由此导致后备时间缩短、以致无法使用。

● 电池在保管期间也会出现老化而导致使用寿命缩短的现象。
请尽快开始使用。

● 请在购买电池后 6 个月以内开始使用。

安装于 UPS 进行保管时，请在保管前充电 8 小时以上，并在保管期间将电源开关切换为“关”状态。保管时间超过 6 个月时，请在超时前重新对电池进行充电。

电池的充电时间请查看“Instruction Manual”。

● 若需要继续保管，则请在保管温度为 25℃以下和 40℃以下时分别以每 6 个月和每 2 个月的间隔对电池重新进行充电。

欧姆龙自动化（中国）有限公司

URL : <http://www.fa.omron.com.cn>